

Property Description
 COM AT SE COR OF SW 1/4 OF NE 1/4 OF SEC 7-36-18
 TH N ALONG E LINE OF SW 1/4 OF NW 1/4 A
 DISTANCE OF 25 FT TH W 1760.4 FT TH N 25 FT FOR
 Situs: 1451 MYRTLE ST SARASOTA 34234

DERR FREDERICK M
 1451 MYRTLE ST
 SARASOTA, FL 34234

2020

Parcel ID: 0026-14-0002

4700 Mineral and gravel

Building Characteristics			
Category	Type	%	Mult.
Roof Material	METAL,	100	1.0100
Floors	CERAMIC	100	1.0100
Frame	MASONRY OR	100	1.0000
Interior Wall	DRYWALL	100	1.0000
Heat-Air	HEAT & AIR	100	1.0000
Roof	LOW PITCH	100	0.9800
Exterior	STUCCO	67	0.6700
Exterior	METAL	33	0.3333
Wall Height	WH	100	0.9600
Size Index	SZ	100	0.9800
Quality Adj.	QA	100	1.1000

Total Adjustments 1.0380

SAR	Area	H	Rate	Cost New
PRM	6,992	X	62.28	435,462
OPF	418		12.52	5,233

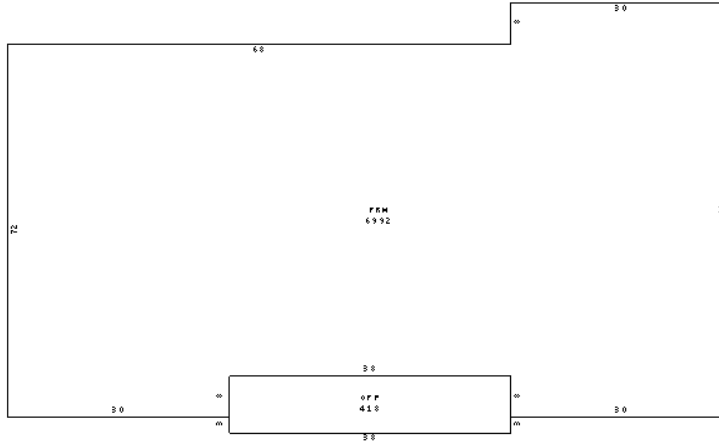

Gross Area: 7,410

Net/Living Area: 6,992

Building: 1 of 1

Category	Units	Cost New
Bathrooms	4.00	0
Extra Fixtures	13.00	0
Wall Height	10.00	0
Number of Stories	1.00	0

Total Replacement Cost New:	440,694
Less Total Depr:	16.00% 70,511
Building Value:	370,183
Depreciation Adj.	Adj.
Average Condition	16.00%

Grade	Description	Nbhd Factor	Mkt Area Factor
D1	Commercial	1.0000	0

AYB	EYB	DT	% Good	Last Inspection
1987	2004	30	84.00%	01/14/2020 546

#	Instrument	Transfer Date	Consideration	Type	QC	QC Description	V/I	Grantor
1	2018127555	09/17/2018	\$430,000	WD	37	Not exposed to	I	SINGLE STREAM RECYCLERS
2	2018121210	09/10/2018	\$100	QC	11	Corrective,	I	SSR PROPERTIES LLC
3	2016161593	12/29/2016	\$1,590,000	WD	05	Qualified -	I	PREFERRED MATERIALS INC
4	2005181920	07/13/2005	\$100	OT	X2	Pre-2009	I	APAC-FLORIDA INC,

#	Code	Description	B#	Qty	Length	Width	Units	Unit Price	Grade	Cond	AYB	EYB	% Depr	Value	Notes
1	FENC	Fence, chain link 6	1	1	0	0	390.00	19.500	AVERAG	AV	1988	1988	46.877	3,565	
2	PAVE	Asphalt paving	1	1	0	0	16,000.00	2.125	AVERAG	FR	1988	1988	56.000	19,040	
3	PARK	Parking Spaces	1	1	0	0	34.00	0.000	AVERAG		1987	1997	0.000	0	
4	UTIL	Utility Building	1	1	9	8	72.00	14.760	AVERAG	AV	1987	1987	45.261	481	

#	Land Type	Land Type Description	Land Use	Units	Unit Type	Base Unit Price	Nbhd Factor	Mkt Factor	Land Influences						Adj. Unit Price	Land Value	
									Code	Fact	Code	Fact	Code	Fact			
1	CLND	Commercial Land	4700	46,663.00	SS	3.65	1		LC	0.90						3.25	151,657

Parcel Notes				
APAC OFFICE				

SARASOTA COUNTY PROPERTY APPRAISER		
PROPERTY RECORD CARD		
VALUE SUMMARY	CURRENT	PRIOR YEAR
Building Value	\$ 370,200	\$ 371,000
Extra Feature Value	\$ 23,100	\$ 23,700
Land Value - Market	\$ 151,700	\$ 130,900
Land Value - Ag	\$ 0	\$ 0
TOTAL JUST VALUE	\$ 545,000	\$ 525,600
Values pertaining to County Assessment		
Assessed Value	\$ 545,000	\$ 525,600
Exemption Codes	None	None
Exemption Amount	\$ 0	\$ 0
Taxable Value	\$ 545,000	\$ 525,600

PARCEL DATA				
Mkt Area	Nbhd	Sub	Lot SqFt	Zoning
204	2440.00	0000	46,663	ILW
Sub Name:	NOT PART OF A SUBDIVISION			
Bldg Type:	Office Building			
CONDOMINIUM INFORMATION				
Floor #	Total Floors	Unit #	View	

Permit Information			
Number	Date	Cost	Description
19	08/19/2019	5,399	INSTALL 26 STEEL
18	01/10/2019	1,900	install, (replace
18	12/03/2018	33,401	A/C change out 5