

**Property Description**  
 COM SE COR NW 1/4 SEC 27-37-18 TH S 89-41-13 W  
 1330.74 FT TH N 77.36 FT TH W 629.31 FT TH N 84 FT  
 TO POB TH N 95.5 FT TH E 57 FT TH N 536.5 FT TH N  
 Situs: 8201 S TAMIAMI TRL SARASOTA 34238

MACYS RETAIL HOLDINGS INC  
 7 W 7TH ST  
 CINCINNATI, OH 45202-2424

2020

Parcel ID: 0123-11-0003

2810 Use In Transition

| Building Characteristics |            |     |        |
|--------------------------|------------|-----|--------|
| Category                 | Type       | %   | Mult.  |
| Exterior                 | BRICK      | 100 | 1.0400 |
| Fire/Sprinkler           | SPRINKLERS | 100 | 1.0000 |
| Frame                    | MASONRY OR | 100 | 1.0000 |
| Heat-Air                 | HEAT & AIR | 100 | 1.0000 |
| Interior Wall            | DRYWALL    | 100 | 1.0000 |
| Roof Material            | BUILT-UP   | 100 | 0.9900 |
| Roof                     | LOW PITCH  | 100 | 0.9800 |
| Floors                   | STONE      | 66  | 0.6798 |
| Floors                   | CERAMIC    | 34  | 0.3434 |
| Wall Height              | WH         | 100 | 1.0000 |
| Size Index               | SZ         | 100 | 0.9600 |
| Quality Adj.             | QA         | 100 | 1.0000 |

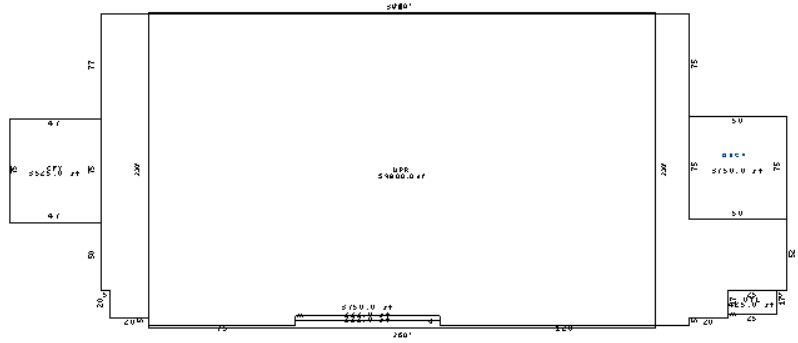

| Total Adjustments |        |   |       |           | 0.9911 |
|-------------------|--------|---|-------|-----------|--------|
| SAR               | Area   | H | Rate  | Cost New  |        |
| PRM               | 70,811 | X | 47.57 | 3,368,479 |        |
| UPR               | 59,800 | X | 38.06 | 2,275,988 |        |
| UTL               | 11,011 |   | 14.27 | 157,127   |        |
| CPY               | 3,525  |   | 14.28 | 50,337    |        |
| UTL               | 425    |   | 14.33 | 6,090     |        |
| UTF               | 222    |   | 9.43  | 2,093     |        |
| UTF               | 222    |   | 9.43  | 2,093     |        |
| OPF               | 222    |   | 9.43  | 2,093     |        |
| NUL               | 0      |   | 0.00  | 0         |        |

Gross Area: 146,238      Net/Living Area: 130,611      Building: 1 of 1

| Category          | Units | Cost New |
|-------------------|-------|----------|
| Bathrooms         | 4.00  | 0        |
| Extra Fixtures    | 43.00 | 0        |
| Number of Stories | 2.00  | 0        |
| Wall Height       | 14.00 | 0        |

| # | Instrument | Transfer Date | Consideration | Type | QC | QC Description | V/I | Grantor |
|---|------------|---------------|---------------|------|----|----------------|-----|---------|
| 1 | 1957/202   | 12/01/1986    | \$3,653,900   | NA   | 11 | Corrective,    | I   |         |

| # | Code | Description           | B# | Qty | Length | Width | Units      | Unit Price | Grade  | Cond | AYB  | EYB  | % Depr  | Value   | Notes |
|---|------|-----------------------|----|-----|--------|-------|------------|------------|--------|------|------|------|---------|---------|-------|
| 1 | ELEV | Elevator - Commercial | 1  | 1   | 0      | 0     | 2.00       | 72900.0000 | AVERAG | AV   | 1977 | 1977 | 0.000   | 0       |       |
| 2 | ESCL | Escalator -           | 1  | 2   | 0      | 0     | 16.00      | 11500.0000 | AVERAG | AV   | 1977 | 1977 | 0.000   | 0       |       |
| 3 | PARK | Parking Spaces        | 1  | 1   | 0      | 0     | 900.00     | 0.0000     | AVERAG | AV   | 1977 | 1977 | 0.000   | 0       |       |
| 4 | PAVE | Asphalt paving        | 1  | 1   | 0      | 0     | 300,000.00 | 1.775      | AVERAG | AV   | 1977 | 1977 | 0.000   | 0       |       |
| 5 | WALL | Concrete block wall   | 1  | 1   | 0      | 0     | 900.00     | 4.984      | LOW    | AV   | 1977 | 1977 | 100.009 | 4,486   |       |
| 6 | IMPA | Impact fee credit     | 1  | 1   | 0      | 0     | 1.00       | 990806.00  | AVERAG | AV   | 2018 | 2018 | 100.000 | 990,806 |       |

|                                    |           |
|------------------------------------|-----------|
| <b>Total Replacement Cost New:</b> | 5,864,049 |
| <b>Less Total Depr:</b> 100.00%    | 5,864,049 |
| <b>Building Value:</b>             | 0         |
| <b>Depreciation Adj. Adj.</b>      |           |
| Average Condition                  | 37.00%    |
| Other external influence (see      | 100.00%   |

| # | Land Type | Land Type Description  | Land Use | Units      | Unit Type | Base Unit Price | Nbhd Factor | Mkt Factor | Land Influences |      |      |      |      |      | Adj. Unit Price | Land Value |
|---|-----------|------------------------|----------|------------|-----------|-----------------|-------------|------------|-----------------|------|------|------|------|------|-----------------|------------|
|   |           |                        |          |            |           |                 |             |            | Code            | Fact | Code | Fact | Code | Fact |                 |            |
| 1 | XS        | Retail Shopping Center | 2810     | 425,469.00 | S         | 7.60            | 1           |            |                 |      |      |      |      |      | 7.60            | 3,233,564  |

| Grade | Description | Nbhd Factor | Mkt Area Factor |                 |
|-------|-------------|-------------|-----------------|-----------------|
| E2    | Commercial  | 1.0000      | 0               |                 |
| AYB   | EYB         | DT          | % Good          | Last Inspection |
| 1977  | 1977        | 30          | 0.00%           | 10/19/2016 427  |

**Parcel Notes**  
 MACYS - STORE CLOSING PUBLISHED JANUARY 4, 2017 SARASOTA HERALD TRIBUNE

| SARASOTA COUNTY PROPERTY APPRAISER     |                     |                     |
|--|---------------------|---------------------|
| PROPERTY RECORD CARD                   |                     |                     |
| VALUE SUMMARY                          | CURRENT             | PRIOR YEAR          |
| Building Value                         | \$ 0                | \$ 0                |
| Extra Feature Value                    | \$ 995,300          | \$ 995,300          |
| Land Value - Market                    | \$ 3,233,600        | \$ 3,403,800        |
| Land Value - Ag                        | \$ 0                | \$ 0                |
| <b>TOTAL JUST VALUE</b>                | <b>\$ 4,228,900</b> | <b>\$ 4,399,100</b> |
| Values pertaining to County Assessment |                     |                     |
| Assessed Value                         | \$ 4,228,900        | \$ 4,399,100        |
| Exemption Codes                        | None                | None                |
| Exemption Amount                       | \$ 0                | \$ 0                |
| Taxable Value                          | \$ 4,228,900        | \$ 4,399,100        |

| PARCEL DATA       |                           |      |          |        |
|-------------------|---------------------------|------|----------|--------|
| Mkt Area          | Nbhd                      | Sub  | Lot SqFt | Zoning |
| 205               | 2207.00                   | 0000 | 425,469  | CG     |
| <b>Sub Name:</b>  | NOT PART OF A SUBDIVISION |      |          |        |
| <b>Bldg Type:</b> | Department Store          |      |          |        |

| CONDOMINIUM INFORMATION |              |        |      |
|-------------------------|--------------|--------|------|
| Floor #                 | Total Floors | Unit # | View |
|                         |              |        |      |

| Permit Information |            |       |                   |
|--------------------|------------|-------|-------------------|
| Number             | Date       | Cost  | Description       |
| 16                 | 09/09/2016 | 6,843 | REPLACE LIKE FOR  |
| 15                 | 08/05/2015 | 2,000 |                   |
| 15                 | 08/05/2015 | 2,000 | install wood sign |