

**Property Description**

BEG NELY COR TRACT D TH S-20-40- 21-W 390 FT FOR  
 POB TH S-20-40- 21-W 160 FT TH N-69-19-39-W 4.11  
 FT TH WLY ALG ARC OF CURV 155 FT TH N-20-40-21-E  
 Situs: 14299 S TAMIAMI TRL NORTH PORT 34287

BANK OF AMERICA  
 CORPORATE REAL ESTATE ASSESSMENTS  
 NC1-001-03-81  
 CHARLOTTE, NC 28255

**2020**

**Parcel ID: 0999-03-4657**

2350 Financial institutions (Retail

Building Characteristics			
Category	Type	%	Mult.
Roof Material	CONCTILE	100	1.0300
Roof	HIP	100	1.0100
Exterior	STUCCO	100	1.0000
Frame	MASONRY OR	100	1.0000
Heat-Air	HEAT & AIR	100	1.0000
Interior Wall	DRYWALL	100	1.0000
Floors	CARPET,	75	0.7500
Floors	WOOD -	25	0.2525
Wall Height	WH	100	1.0000
Size Index	SZ	100	0.9900
Quality Adj.	QA	100	2.0000

Total Adjustments 2.0649

SAR	Area	H	Rate	Cost New
PRM	5,086	X	227.14	1,155,234
CYE	735		136.28	100,166

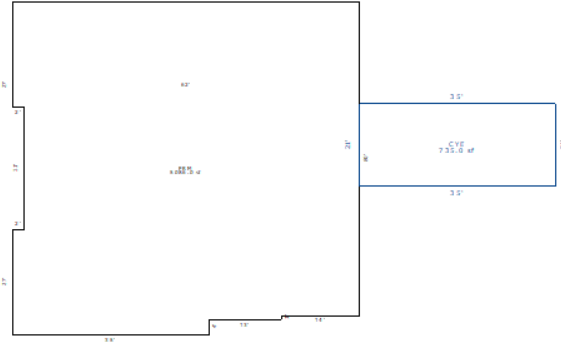

Gross Area: 5,821 Net/Living Area: 5,086 Building: 1 of 1

Category	Units	Cost New
Bathrooms	3.00	0
Extra Fixtures	7.00	0
Number of Stories	1.00	0
Wall Height	14.00	0

<b>Total Replacement Cost New:</b>	1,255,403
<b>Less Total Depr:</b> 10.00%	125,540
<b>Building Value:</b>	1,129,863
<b>Depreciation Adj.</b> Adj.	
Average Condition	10.00%

#	Instrument	Transfer Date	Consideration	Type	QC	QC Description	V/I	Grantor
1	1242/1993	06/01/1978	\$85,000	NA	01	Sale qualified	I	

#	Code	Description	B#	Qty	Length	Width	Units	Unit Price	Grade	Cond	AYB	EYB	% Depr	Value	Notes
1	PARK	Parking Spaces	1	1	0	0	14.00	0.000	AVERAG		1978	2000	0.000	0	
2	PAVE	Asphalt paving	1	1	0	0	9,300.00	3.218	GOOD	AV	1988	2000	74.988	22,442	
3	PAVE	Concrete paving	1	1	0	0	720.00	8.366	GOOD	AV	1988	2000	74.989	4,517	

#	Land Type	Land Type Description	Land Use	Units	Unit Type	Base Unit Price	Nbhd Factor	Mkt Factor	Land Influences						Adj. Unit Price	Land Value
1	YB	Retail Banks	2350	25,465.00	S	12.00	1		Code	Fact	Code	Fact	Code	Fact	17.89	455,589

Grade	Description	Nbhd Factor	Mkt Area Factor
A2	Commercial	1.0000	0

AYB	EYB	DT	% Good	Last Inspection
1978	2010	30	90.00%	02/05/2019 403

SARASOTA COUNTY PROPERTY APPRAISER		
PROPERTY RECORD CARD		
VALUE SUMMARY	CURRENT	PRIOR YEAR
Building Value	\$ 1,129,900	\$ 1,142,400
Extra Feature Value	\$ 26,900	\$ 27,400
Land Value - Market	\$ 455,600	\$ 455,600
Land Value - Ag	\$ 0	\$ 0
<b>TOTAL JUST VALUE</b>	<b>\$ 1,612,400</b>	<b>\$ 1,625,400</b>
Values pertaining to County Assessment		
Assessed Value	\$ 1,612,400	\$ 1,625,400
Exemption Codes	None	None
Exemption Amount	\$ 0	\$ 0
Taxable Value	\$ 1,612,400	\$ 1,625,400

PARCEL DATA				
Mkt Area	Nbhd	Sub	Lot SqFt	Zoning
203	2209.00	1502	25,465	CG
<b>Sub Name:</b>	PORT CHARLOTTE SUB 03			
<b>Bldg Type:</b>	Bank-Branch			

CONDOMINIUM INFORMATION			
Floor #	Total Floors	Unit #	View

Permit Information			
Number	Date	Cost	Description
180000418	07/02/2018	250,000	COMMERCIAL NEW
180000418	07/02/2018	100,000	COMMERCIAL NEW
150000097	03/27/2015	220,357	interior &