

Situs: 1038 25TH ST SARASOTA 34234

0820 2-Family Dwelling

Building Characteristics			
Category	Type	%	Mult.
Arch Style	TWO FAMILY	100	1.0000
Exterior	STUCCO	90	0.9000
Exterior	WOOD SIDNG	10	0.1025
Floors		0	0.0000
Floors	CARPET,	100	1.0000
Foundation	CONC. SLAB	100	1.0000
Frame	MASONRY OR	100	1.0000
GulfBay	MAINLAND	100	1.0000
Heat-Air	HEAT & AIR	100	1.0000
Interior Wall	DRYWALL	100	1.0000
Quality Adj.	QA	100	0.8000
Roof Material	ASPHALT OR	100	1.0000
Roof	HIP	100	1.0100
Size Index	SZ	100	1.0226
Wall Height	WH	100	1.0000

Total Adjustments 0.8283

SAR	Area	H	Rate	Cost New
MLA	1,550	X	74.55	115,553

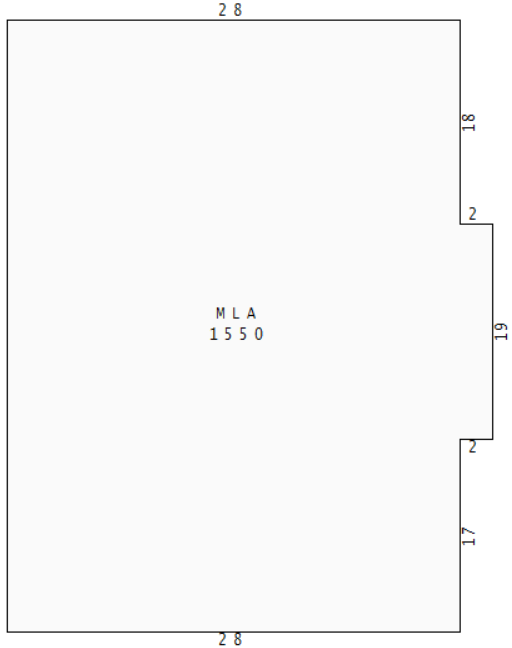

Gross Area: 1,550

Net/Living Area: 1,550

Building: 1 of 1

Category	Units	Cost New
Bathrooms	2.00	20,000
Bedrooms	2.00	0
Living Units	2.00	0
Rooms	4.00	0
Number of Stories	1.00	0
Half Baths	0.00	0
Kitchens	2.00	0
Wall Height	8.00	0
Extra Fixtures	0.00	0

<b>Total Replacement Cost New:</b>	132,119
<b>Less Total Depr:</b> 48.00%	63,417
<b>Building Value:</b>	68,702
<b>Depreciation Adj.</b>	Adj.
Fair Condition	48.00%

Grade	Description	Nbhd Factor	Mkt Area Factor
20	Res Low	1.0000	0

AYB	EYB	DT	% Good	Last Inspection
1972	1980	10	52.00%	04/26/2016 631

#	Instrument	Transfer Date	Consideration	Type	QC	QC Description	V/I	Grantor
1	2013100872	07/18/2013	\$75,000	WD	38	Sale under	I	DOWIE MICHAEL C
2	2005132486	06/16/2005	\$270,000	WD	01	Sale qualified	I	JACKSON BOOKER T &
3	2674/969	09/30/1994	\$67,000	WD	01	Sale qualified	I	PERKINS ROBERT E
4	982/30	11/01/1972	\$30,000	NA	01	Sale qualified	I	

#	Code	Description	B#	Qty	Length	Width	Units	Unit Price	Grade	Cond	AYB	EYB	% Depr	Value	Notes

#	Land Type	Land Type Description	Land Use	Units	Unit Type	Base Unit Price	Nbhd Factor	Mkt Factor	Land Influences						Adj. Unit Price	Land Value
1	MLND	Main Land	NA	7,550.00	SN	22.45	1		Code	Fact	Code	Fact	Code	Fact	24.60	185,708

Grade		Description		Nbhd Factor		Mkt Area Factor		Parcel Notes							
20	Res Low	1.0000	0	2017 IMPR_MDL TO MFRS TWO 4RM/2BR/1BA. NO ACCESS - INT EST 3/04											

SARASOTA COUNTY PROPERTY APPRAISER  
 PROPERTY RECORD CARD

VALUE SUMMARY	CURRENT	PRIOR YEAR
Building Value	\$ 68,700	\$ 58,000
Extra Feature Value	\$ 0	\$ 0
Land Value - Market	\$ 185,700	\$ 185,700
Land Value - Ag	\$ 0	\$ 0
<b>TOTAL JUST VALUE</b>	<b>\$ 254,400</b>	<b>\$ 243,700</b>

Values pertaining to County Assessment		
Assessed Value	\$ 183,180	\$ 166,527
Exemption Codes	None	None
Exemption Amount	\$ 0	\$ 0
Taxable Value	\$ 183,180	\$ 166,527

PARCEL DATA				
Mkt Area	Nbhd	Sub	Lot SqFt	Zoning
602	6216.00	0604	7,550	RMF4

Sub Name:	GREENWOOD
Bldg Type:	Multi-Family Res Structure

CONDOMINIUM INFORMATION			
Floor #	Total Floors	Unit #	View

Permit Information			
Number	Date	Cost	Description
2021-	05/19/2021	2,500	*OTC*Run 3" PVC
20110944	11/30/2010	2,850	CHANGE OUT--ONE
20071079	12/04/2006	2,000	REPLACE 4" SEWER