

Situs: 2587 COLORADO ST SARASOTA 34237

0100 Single Family Detached

Building Characteristics			
Category	Type	%	Mult.
GulfBay	MAINLAND	100	1.0000
Floors	CARPET,	100	1.0000
Foundation	CONC. SLAB	100	1.0000
Frame	MASONRY OR	100	1.0000
Heat-Air	HEAT & AIR	100	1.0000
Interior Wall	DRYWALL	100	1.0000
Roof Material	ASPHALT OR	100	1.0000
Roof	GABLE	100	0.9900
Exterior Floors	CONC BLK	100	0.9750
Wall Height	WH	100	1.0000
Size Index	SZ	100	1.0420
Quality Adj.	QA	100	1.0000

Total Adjustments 1.0058

SAR	Area	H	Rate	Cost New
MLA	1,436	X	84.03	120,667
AGA	588		29.44	17,311
SPA	209		22.52	4,707
OPA	30		22.40	672

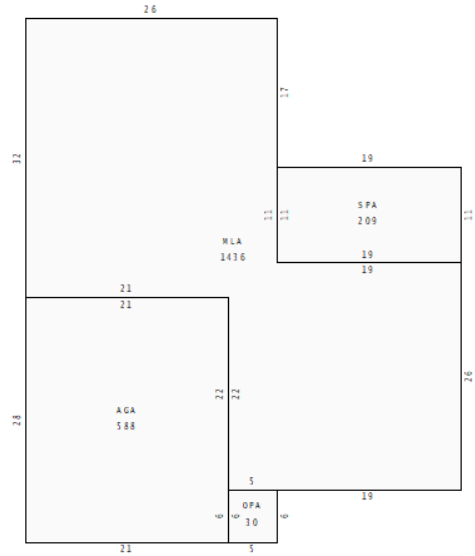

Sketch by Apex Sketch v5 Pro™

Gross Area: 2,263 Net/Living Area: 1,436 Building: 1 of 1

SARASOTA COUNTY PROPERTY APPRAISER
 PROPERTY RECORD CARD

VALUE SUMMARY	CURRENT	PRIOR YEAR
Building Value	\$ 22,200	\$ 30,600
Extra Feature Value	\$ 0	\$ 300
Land Value - Market	\$ 133,500	\$ 132,000
Land Value - Ag	\$ 0	\$ 0
TOTAL JUST VALUE	\$ 155,700	\$ 162,900
Values pertaining to County Assessment		
Assessed Value	\$ 85,147	\$ 83,559
Exemption Codes	604 910 999	604 910 999
Exemption Amount	\$ 50,500	\$ 50,500
Taxable Value	\$ 34,647	\$ 33,059

PARCEL DATA

Mkt Area	Nbhd	Sub	Lot SqFt	Zoning
604	6432.00	1632	9,480	RSF3

Sub Name: RINGLING BLVD SUB REPLAT OF BLK E
 Bldg Type: Single Family Detached

CONDOMINIUM INFORMATION

Floor #	Total Floors	Unit #	View

Permit Information

Number	Date	Cost	Description
20091857	3/18/2009	7,428	A/C CHANGE OUT-
20040964	11/24/2003	6,600	PITCH 3/12 24

Category	Units	Cost New
Bathrooms	2.00	5,000
Bedrooms	3.00	0
Living Units	1.00	0
Rooms	5.00	0
Number of Stories	1.00	0
Half Baths	0.00	0
Kitchens	1.00	0
Wall Height	8.00	0
Extra Fixtures	0.00	0

Total Replacement Cost New:	148,283
Less Total Depr: 85.00%	126,041
Building Value:	22,242
Depreciation Adj. Adj.	
Fair Condition	85.00%

#	Instrument	Transfer Date	Consideration	Type	QC	QC Description	V/I	Grantor
1	846/195	6/1/1970	\$25,500	NA	01	Sale qualified	I	

#	Code	Description	B#	Qty	Length	Width	Units	Unit Price	Grade	Cond	AYB	EYB	% Depr	Value	Notes
1	SHED	Shed no value - <160	1	1	0	0	100.00	0.000	AVERAG	GD	1985	1985	0.000	0	

#	Land Type	Land Type Description	Land Use	Units	Unit Type	Base Unit Price	Nbhd Factor	Mkt Factor	Land Influences						Adj. Unit Price	Land Value
1	MLND	Main Land	NA	9,480.00	SN	13.50	1		Code	Fact	Code	Fact	Code	Fact	14.08	133,488

Grade	Description	Nbhd Factor	Mkt Area Factor
30	Res Avg	0.9800	0

AYB	EYB	DT	% Good	Last Inspection
1970	1980	13	15.00%	3/24/2015 623

Parcel Notes
 ROOF IS NEWER 06/09 590.