

Situs: 3844 WOLVERINE ST SARASOTA 34232

0100 Single Family Detached

Building Characteristics			
Category	Type	%	Mult.
GulfBay	MAINLAND	100	1.0000
Exterior	STUCCO	100	1.0000
Floors	NO	100	1.0000
Foundation	CONC. SLAB	100	1.0000
Frame	MASONRY OR	100	1.0000
Heat-Air	HEAT & AIR	100	1.0000
Interior Wall	DRYWALL	100	1.0000
Roof Material	ASPHALT OR	100	1.0000
Roof	GABLE	100	0.9900
Floors		0	0.0000
Arch Style	STANDARD	100	0.0000
Wall Height	WH	100	1.0000
Size Index	SZ	100	1.2020
Quality Adj.	QA	100	0.8200

Total Adjustments 0.9758

SAR	Area	H	Rate	Cost New
MLA	851	X	84.41	71,833
SPA	322		22.81	7,345
CPF	200		14.35	2,870
UTL	72		35.17	2,532
OPA	36		21.11	760

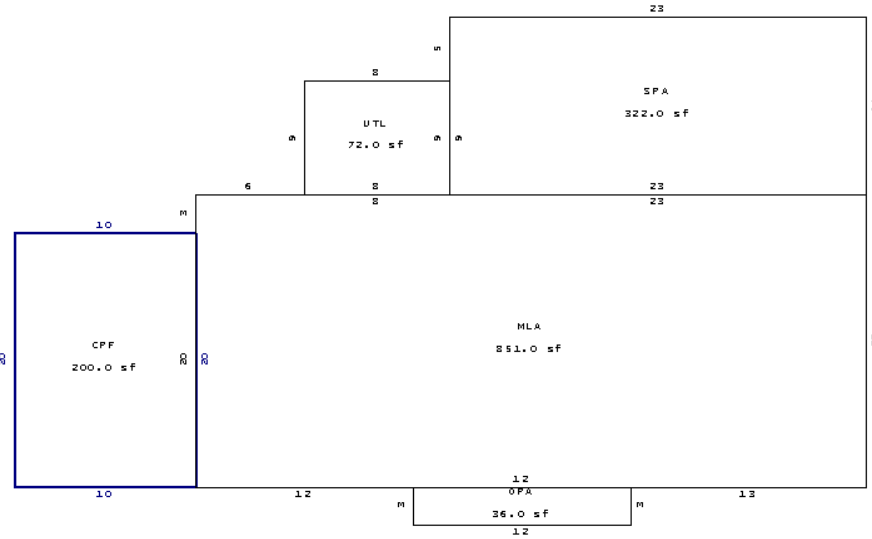

Gross Area: 1,481 Net/Living Area: 851 Building: 1 of 1

Category	Units	Cost New
Bathrooms	1.00	0
Bedrooms	3.00	0
Living Units	1.00	0
Rooms	5.00	0
Number of Stories	1.00	0
Half Baths	0.00	0
Kitchens	1.00	0
Wall Height	8.00	0
Extra Fixtures	0.00	0

Total Replacement Cost New:	85,339
Less Total Depr: 38.00%	32,429
Building Value:	52,910
Depreciation Adj. Adj.	
Average Condition	38.00%

Grade	Description	Nbhd Factor	Mkt Area Factor
20	Res Low	1.0000	0

#	Instrument	Transfer Date	Consideration	Type	QC	QC Description	V/I	Grantor
1	2012116025	05/14/2012	\$42,000	QC	11	Corrective,	I	NSF DEVELOPMENT LLC,
2	2012044051	04/05/2012	\$42,000	WD	37	Not exposed to	I	STEPHENS, JOSEPH
3	2005209149	09/08/2005	\$210,000	WD	01	Sale qualified	I	PETTIT, KAREN L
4	2000041026	03/31/2000	\$72,000	WD	01	Sale qualified	I	LEWIS RUTH C,

#	Code	Description	B#	Qty	Length	Width	Units	Unit Price	Grade	Cond	AYB	EYB	% Depr	Value	Notes
1	MLND	Main Land	NA				8,112.00	S	8.85	1					

#	Land Type	Land Type Description	Land Use	Units	Unit Type	Base Unit Price	Nbhd Factor	Mkt Factor	Land Influences						Adj. Unit Price	Land Value
1	MLND	Main Land	NA	8,112.00	S	8.85	1		Code	Fact	Code	Fact	Code	Fact	8.52	69,078

Grade	Description	Nbhd Factor	Mkt Area Factor
20	Res Low	1.0000	0

AYB	EYB	DT	% Good	Last Inspection
1960	1985	10	62.00%	04/02/2020 753

SARASOTA COUNTY PROPERTY APPRAISER		
PROPERTY RECORD CARD		
VALUE SUMMARY	CURRENT	PRIOR YEAR
Building Value	\$ 52,900	\$ 45,800
Extra Feature Value	\$ 0	\$ 0
Land Value - Market	\$ 69,100	\$ 86,800
Land Value - Ag	\$ 0	\$ 0
TOTAL JUST VALUE	\$ 122,000	\$ 132,600
Values pertaining to County Assessment		
Assessed Value	\$ 120,981	\$ 109,983
Exemption Codes	None	None
Exemption Amount	\$ 0	\$ 0
Taxable Value	\$ 120,981	\$ 109,983

PARCEL DATA				
Mkt Area	Nbhd	Sub	Lot SqFt	Zoning
604	6434.00	1530	8,112	RSF3
Sub Name: EASTWOOD OAKS UNIT 4				
Bldg Type: Single Family Detached				
CONDOMINIUM INFORMATION				
Floor #	Total Floors	Unit #	View	

Permit Information			
Number	Date	Cost	Description
20183057	02/01/2018	4,000	REROOF 14 SQS

#	Code	Description	B#	Qty	Length	Width	Units	Unit Price	Grade	Cond	AYB	EYB	% Depr	Value	Notes
1	MLND	Main Land	NA				8,112.00	S	8.85	1					

Parcel Notes															
ROOF 2018 + WINDOWS NOT ORIGINAL - 703 12/2018															
QUALITY GRADE CHANGE ALL EXCEPT BEARDED OAKS															
MINOR DEF, A/C YES.															